

Gen3 LED Visor Light #ELV3BVS+(x)

**NEW
GEN3 LED
Visor Light**

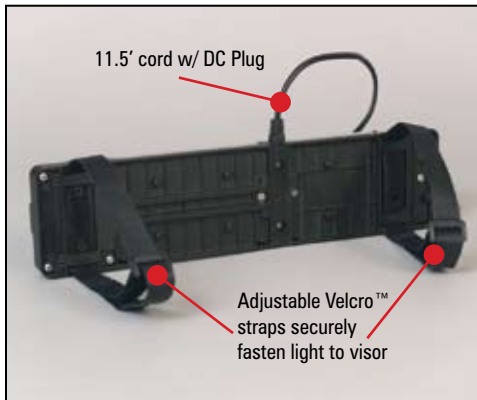

11.05" length x 2.63" height x 0.85" depth



Features

- All new Generation 3 LED Visor Light is smaller and more powerful to provide undercover lighting that is sure to be seen.
- The Gen3 LED Visor Light is easy to install - just plug into a 12 Vdc outlet and securely strap to the visor with adjustable Velcro™ straps. Light may be hard wired for undercover vehicles to discreetly hide wires when needed.
- Non-volatile memory recalls last flash pattern used at power up.
- Features 16 built-in flash patterns and 5 color combinations (see color codes below).
- Ideal for undercover detectives, law enforcement professionals and security staff for undercover or supplemental windshield lighting.
- Built-in protection from reverse polarity and voltage spikes.
- Current Draw: 0.75 amps @ 12.8 Vdc and 0.35 amps @ 25.6 Vdc.
- 10 - 30 Vdc for world wide use.
- Available colors (driver side/passenger side): J=Red/Blue, B=Blue/Blue, R=Red/Red, A=Amber/Amber and D=Red/White.

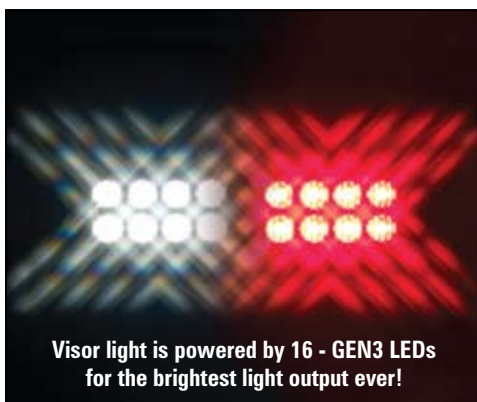
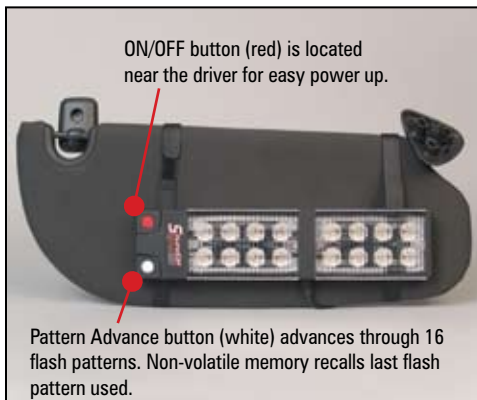

Gen3 LED Visor Light

1.800.338.7337 / www.soundoffsignal.com

**SoundOff
Signal**
an employee owned company