

SHO-ME®

Installation and Maintenance Instructions Model # 02.6052-6116 LED Arrow Board with Controller

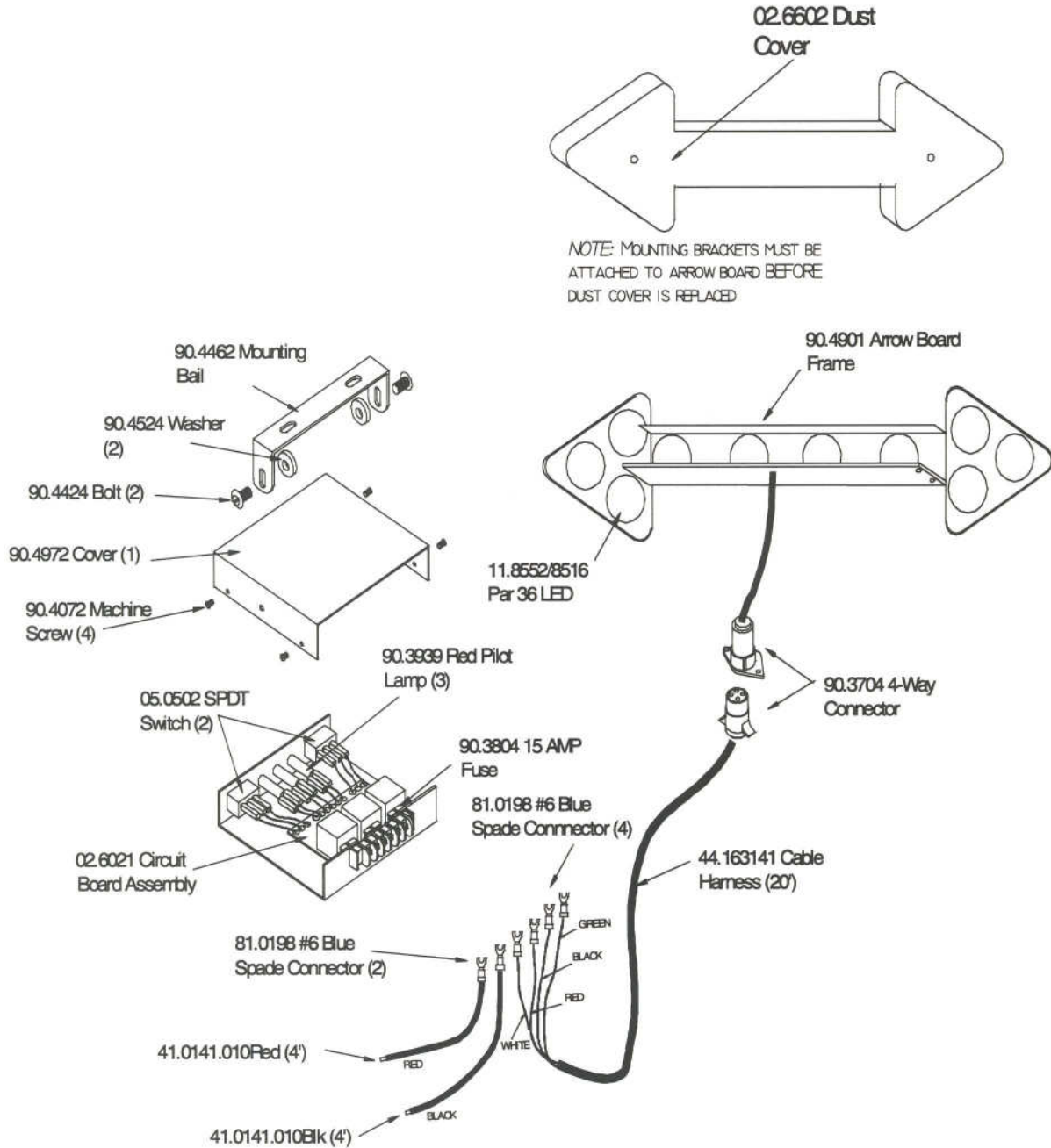

PRODUCTS COMPANY • 804 East Hwy. 248 • Cassville, MO 65625
U.S. and Canada Toll Free Numbers • Phone: 800-641-4098 FAX: 800-526-1240
E-mail: sales@able2products.com WEB: www.able2products.com

02.6052/6116
LED Arrow Board
Wiring

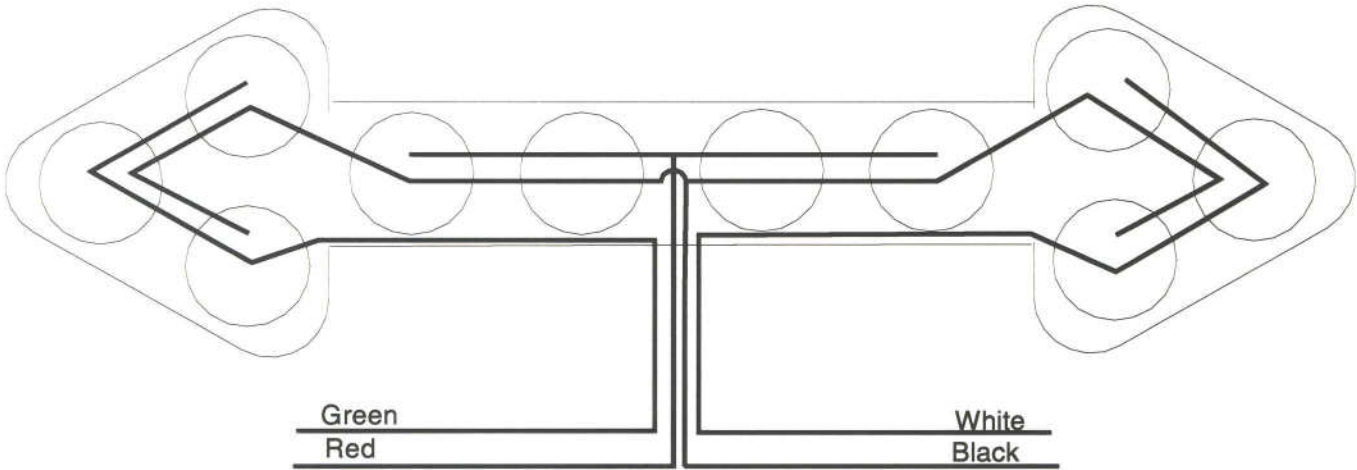

LIMITED WARRANTY

Able 2 Products Company warrants each new product (except bulbs and strobe tubes) to be free from defects in material and workmanship for a period of two years from the date of purchase. During this warranty period, the obligation of Able 2 is limited to repairing or replacing, as Able 2 may elect, any part or parts, which after examination by Able 2 are determined to be defective, when they are delivered pre-paid. This limited warranty does not cover travel expense, the cost of specialized equipment for gaining access to the product, or labor charges for the removal and re-installation of the product.

Able 2 Products Company shall not be liable for incidental or consequential damages, including but not limited to: Loss of use of vehicle, Rental of substitute vehicle, Loss of time, Loss of work, Inconvenience, Transportation expenses, Telephone, Lodging, Loss of revenue, Loss of and/or damage to personal property for or arising out of breach of any express or implied warranty of its products.

Use of lamp or other electrical load of a wattage higher than installed or recommended by the factory, or use of inappropriate or inadequate wiring or circuit protection causes this limited warranty to become void. Able 2 Products Company will in no way be liable for any loss of profits or any indirect or consequential damages arising out of any such defect in material and workmanship whether loss is due to negligence or breach of warranty. This limited warranty does not apply to shipping damage, accident, alteration, tampering, misuse or abuse and unauthorized service.

This limited warranty is expressly in lieu of all other express or implied warranties, including the implied warranty of merchantability and the implied warranty of fitness for a particular purpose, and of all other obligations or liabilities on the part of Able 2 Products Company. There are no warranties, unless expressed in authorized Able 2 literature, which extend beyond the description of the face hereof. No dealer, distributor, employee, or representative of the company is authorized to change this warranty in any way or to grant any other warranty.

PRODUCT RETURNS

If a product must be returned, contact our factory by calling 1-800-641-4098 to obtain a Return Authorization Number (RA) before you ship the product. Write the RA Number clearly on the package and return it to Able 2 Products Company, P.O. Box 543, 804 E. Hwy. 248, Cassville, MO 65625-0543. A packing slip should be included with all shipments listing the sender's name, address, daytime phone number and description of defect. Your product will be put in first-class operating condition or replaced with a new part, and returned pre-paid.

Installation And Maintenance Instructions For **SHO-ME®**

Model 02.6052-6116 LED Arrow Board
with Controller

All connections are external. There is no need to open the control box during the installation process.

1. Remove dust cover by removing the two lock nuts and washers located on the back of the arrow board.
2. Mount the **SHO-ME®** Traffic Guide Directional Arrow Board on the vehicle as desired.
3. Replace dust cover.
4. Route the cable from the Arrow Board to the driver's compartment or wherever the control box will be located.
5. A mounting bracket is provided for easy installation of the control box. Determine a suitable position for the mounting bracket and attach it to the vehicle with appropriate fasteners.
6. Connect the bare end of **HEAVY BLACK** wire to a suitable chassis ground.
7. Connect spade connector of **HEAVY BLACK** wire to screw marked "NEG" on terminal strip.
8. Connect spade connector of white wire from arrow board cable to screw marked "W" on terminal strip.
9. Connect spade connector of red wire from arrow board cable to screw marked "R" on terminal strip.
10. Connect spade connector of black wire from arrow board cable to screw marked "B" on terminal strip.
11. Connect spade connector of green wire from arrow board cable to screw marked "G" on terminal strip.
12. Connect spade connector of **HEAVY RED** wire to screw marked "POS" on terminal strip.
13. Connect bare end of the **HEAVY RED** wire to a 12-volt positive power source.
14. Assemble the control box to the bracket.

****NOTE****

These instructions assume that the Arrow Boards are facing the rear of the vehicle. However, if the arrow boards are flashing to the left when the pilot lamps on the control box indicate that they should be flashing to the right and vice versa, the situation can be corrected by connecting the white wire to the terminal marked "G", and the green wire to the terminal marked "W".

After completing the installation, always check the direction that the Arrow Board Panels are flashing, and be sure that it coincides with the direction indicated by the control box pilot lamps.

MAINTENANCE INSTRUCTIONS

TROUBLE SHOOTING

1. If the **SHO-ME®** Traffic Guide Arrow Board is not operating properly or is not lighting to full brilliance, make sure all wire connections made during the installation process are secure and the power source is active. Take particular care in making certain that ground connections are properly made.
2. If the Arrow Board is still not working, check the internal 10 amp fuse, in the controller.